

# MEASURING FOR INSIDE MOUNT BLINDS & SHADES

Measure every window, even if they appear identical. Use a metal tape measure to ensure accuracy. Round down to the nearest 1/8". Write all measurements on the measurement worksheets provided.

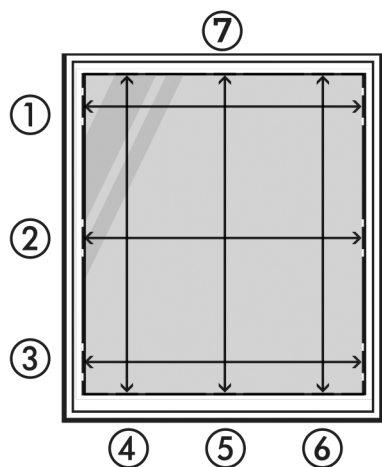

## 1. MEASURE LEFT TO RIGHT (1, 2 & 3)

Measure the window opening inside the frame from left to right, in three places as shown, to determine width. Round down to the nearest 1/8".

- When ordering **Roller/Solar Shades, Sheer Shades or Vertical Blinds**, use the top measurement ① for width.
- When ordering all other products, use the smallest measurement of the three taken for the width. **This will be your ordering width.**

## 2. MEASURE TOP TO BOTTOM (4, 5 & 6)

Measure the window opening from top to bottom in three places as shown to determine height.

- For the height, use the largest measurement of the three taken. Round up to the nearest 1/8". **This will be your ordering height.**

## 3. MEASURE WINDOW DEPTH (7)

Measure depth of the window frame at the top of the window, where the brackets will be installed. If there is an obstruction lower down (for example, a handle or crank), measure from the obstruction to the window frame and use that measurement.

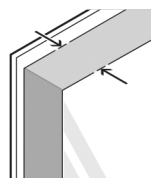

## 4. WRITE these measurements on the measure sheet in this guide.

## CONSIDERATIONS

### MINIMUM DEPTH REQUIRED

Inside Mounted treatments require a minimum depth to be mounted. You will need at least this much unobstructed depth, including any handles, locks, etc., to Inside Mount a treatment. The **charts on pg 5** show you the minimum obstruction depth required for each treatment.

### FLUSH MOUNT

For the face of your treatment to be flush with the wall/trim, your frame depth must be the same or greater than the Flush Mount depth indicated on the **chart on pg 5**.

### LIGHT GAPS

A small deduction in the width and/or length will be taken by the factory to allow for correct operation. This will cause small light gaps on each side of the treatment. Give us your exact window dimensions to ensure your treatment operates properly. **Do Not Adjust Your Measurements.**

### 2-ON-1 HEADRAIL

Combine two treatments on one headrail for maximum light control. They can be raised independently, yet convey a uniform, streamlined appearance. **NOTE: For Wood Blinds ordered as 2 or more blinds with 1 valance, add the width of the moulding or mullion, if any, to the custom valance length, or the valance will be too narrow.**

### CORDED CONTROL

You have the option to place the control (lift/tilt) on the right or left side. Pick the side that is easiest to reach.

### STACKING

When your blinds or shades are fully raised, the "stack" will be gathered at the top of your window, obscuring your view. You cannot avoid this obstruction. If you want to retain all of your view, use outside mount and order your treatment to stack above the window opening.

